

Features

- Input voltage: 220–240 V AC, 50/60 Hz
- Input voltage range: 198–264 V AC
- Electrical protection class 1
- IP: 65
- IK: 10++ / 80 joules
- Incandescent wire test 850 °C / 30 s
- Rated ambient operating temperature: 25 °C to NF EN 60598-1 standard
- VK45 surface mounted, VK46 ceiling mounted, VK46 flush mounted
- CRI: 80
- SDCM (Standard Deviation Colour Matching): 3
- Photobiological hazard: RG0
- Lumen maintenance: L80B10 / over 72,000 hours
- Lumen maintenance: L90B50 / 52,000 hours

Applications

- Technical luminaire in EZ steel version for indoor or outdoor environment
- Stainless version: 316L brushed stainless for severe corrosive environments (seaside), indoor and outdoor
- Stainless version: 304L painted stainless for indoor or outdoor environment
- Installation positions: refer to installation instructions

Materials

- Base: 1 mm thick zinc-plated steel, frame 2 mm thick ZP steel
- Stainless version: 316L brushed stainless body and frame
- Stainless version: 304L painted stainless body and frame
- Diffuser: opal polycarbonate
- RoHS: the products contain no prohibited substances as defined in the European Directive 2011/65/UE and amendments

Colours / Finish

- Standard colour: graphite grey RAL7016, abrasion-resistant polyester paint finish, withstands polluting chemical elements
- 316L brushed stainless
- 304L painted stainless: graphite grey RAL7016, abrasion-resistant polyester paint finish, withstands polluting chemical elements

Wiring

- Supply terminal block: automatic, dual-entry, for 3 × 1.5 mm² conductors
- 2 side cable entries for M20 cable gland (not supplied)

Fixings

- Diffuser: retained by M5 stainless 2-point tamper-proof screws with sealing washers

Facilities available

- Flat Duroflam® diffuser: add the suffix **9413** to the product code – example: 64xxxxxx **9413**
- Anti-graffiti protection: add the suffix **9601** to the product code – example: 64xxxxxx **9601**
- Stainless crosspoint screws (VK54): add the suffix **9702** to the product code – example: 64xxxxxx **9702**

Tools

(to be ordered separately)

- M5 bit for 2-point tamper-proof screws – code: **98000003**
- M5 bit-holder screwdriver – code: **98000005**

Approvals

Certificates available:

- CE certificate (as per EN60598-1 / 2-1 / 2-2)
- Incandescent Wire Test certificate (depending on product)

Dimensions

TITAN COMPACT Angle

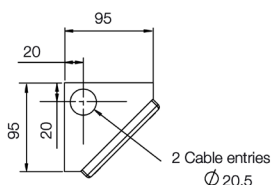

TITAN COMPACT Wall mounted

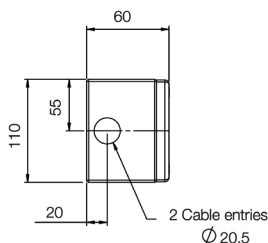

TITAN COMPACT E
(Recessed version)

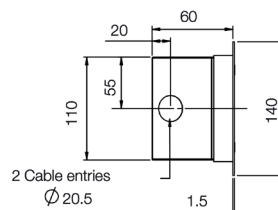

Fixing (E) for wall mounting and recessed version :

- 260 mm (for version 1 module LLC)
- 440 mm (for version 2 modules LLC)
- 600 mm (for version 3 modules LLC)
- 700 mm (for version 4 modules LLC)

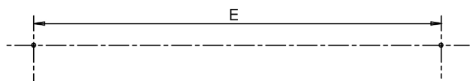

Recess dimensions (TITAN COMPACT E - Recessed version):

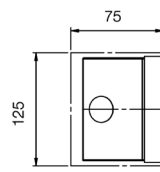

LENGTH:

- 390 mm (for version 1 module LLC)
- 675 mm (for version 2 modules LLC)
- 960 mm (for version 3 modules LLC)
- 1245 mm (for version 4 modules LLC)

Fixing (E) for angle version :

- 120 mm (for version 1 module LLC)
- 220 mm (for version 2 modules LLC)
- 350 mm (for version 3 modules LLC)
- 350 mm (for version 4 modules LLC)



Technical and dimensional data are given for information only and may be modified at any time without notice. Please enquire before ordering.

TITAN COMPACT (surface mounted)						
Designation	CCT (K)	Power (W)	Luminaire light output (lm)	Luminaire efficacy (lm)	Frame length (mm)	Code EZ steel
1 x 1300lm	3000K	11	750	68	375	64011300
1 x 1300lm	4000K	11	800	73	375	64011400
2 x 1300lm	3000K	21	1750	83	660	64021300
2 x 1300lm	4000K	21	1800	86	660	64021400
3 x 1300lm	3000K	31	2650	85	945	64031300
3 x 1300lm	4000K	31	2750	89	945	64031400
4 x 1300lm	3000K	43	3500	81	1230	64041300
4 x 1300lm	4000K	43	3650	85	1230	64041400

TITAN COMPACT ANGLE						
Designation	CCT (K)	Power (W)	Luminaire light output (lm)	Luminaire efficacy (lm)	Frame length (mm)	Code EZ steel
1 x 1300lm	3000K	11	750	68	375	64111300
1 x 1300lm	4000K	11	800	73	375	64111400
2 x 1300lm	3000K	21	1750	83	660	64121300
2 x 1300lm	4000K	21	1800	86	660	64121400
3 x 1300lm	3000K	31	2650	85	945	64131300
3 x 1300lm	4000K	31	2750	89	945	64131400
4 x 1300lm	3000K	43	3500	81	1230	64141300
4 x 1300lm	4000K	43	3650	85	1230	64141400

TITAN COMPACT E stainless steel								
Designation	CCT (K)	Power (W)	Luminaire light output (lm)	Luminaire efficacy (lm)	Aperture Length (mm)	Frame length (mm)	Code 316L	Code 304L
1 x 1300lm	3000K	11	750	68	390	405	64218300	64251300
1 x 1300lm	4000K	11	800	73	390	405	64218400	64251400
2 x 1300lm	3000K	21	1750	83	675	690	64228300	64261300
2 x 1300lm	4000K	21	1800	86	675	690	64228400	64261400
3 x 1300lm	3000K	31	2650	85	960	975	64238300	64271300
3 x 1300lm	4000K	31	2750	89	960	975	64238400	64271400
4 x 1300lm	3000K	43	3500	81	1245	1260	64248300	64281300
4 x 1300lm	4000K	43	3650	85	1245	1260	64248400	64281400