

# GuideLed SL 13811, 13821 CGLine+

Safety luminaire, ceiling recessed mounting



## GuideLed SL 13811, 13821 CGLine+

- LED self contained luminaire with automatic test for reduced inspection effort
- Universal use for maintained and non-maintained operation and for 1 h, 3 h or 8 h operation
- For autonomous installation or connection to the CGLine+ monitoring system
- Environmentally-friendly due to modern lithium ion technology
- Low operating costs via low connected load
- Minimum maintenance effort via high LED service life (50,000 hours)
- Available with special optics for escape route illumination or open-area illumination
- High spacing via double optics technology and highly efficient High Power LEDs
- Simple fault analysis and status display via bicolor LED and testing button
- 1 minute switch-back delay after mains return
- Blocking function prevents unintended discharge during idle operating times (only with CGLine+ WEB-Controller)

13811 CGLine+ with asymmetric optics



5 13821 CGLine+ with symmetric optics

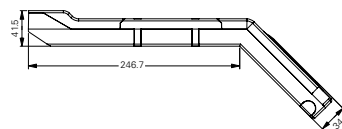
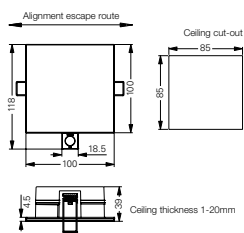

Required height in cavity ceiling for recessing through ceiling cut-out: 150 mm

Luminous flux (mains operation)	asymmetric optics symmetric optics	210 lm 204 lm
Luminous flux $\Phi_E/\Phi_N$ at end of rated operating time		100 % at 1 h; 65 % at 3 h; 25 % at 8 h
Housing material	luminaire module housing	Polycarbonate, aluminium (heat sink) Polycarbonate
Housing colour		White, similar to RAL 9010
Weight		0.96 kg
Type of mounting		Ceiling recessing
Terminals		Through-wiring from mains (L, L', N, PE) to 2.5 mm <sup>2</sup> CGLine+ bus through-wiring to 1.5 mm <sup>2</sup>
Connection voltage		220 - 240 V AC, 50/60 Hz
Power consumption mains operation (apparent power / effective power)		6.9 VA / 6.7 W
Permissible ambient temperature		Maintained mode -5 °C to +30 °C Non-maintained mode 0 °C to +35 °C
Battery		Lithium ion 3.7 V/4000 mAh with multiple protective circuit
Light source		HighPower LEDs 2 x 1.6 W

## Ordering details

Scope of delivery	Order No.
GuideLed SL ceiling recessed 13811 1-8 h/D CGLine+ with asymmetric optics for escape route illumination, clamping range for ceiling thickness 0 - 20 mm, white RAL 9010, supply electronics in housing with cable strain-relief	40071353275
GuideLed SL ceiling recessed 13821 1-8h/D CGLine+ with symmetric optics for anti-panic/open-area illumination, clamping range for ceiling thickness 0 - 20 mm, white RAL 9010, supply electronics in housing with cable strain-relief	40071353274

\* Degree of protection of the luminaire: IP41  
Degree of protection of the housing: IP20

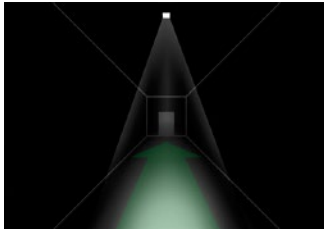
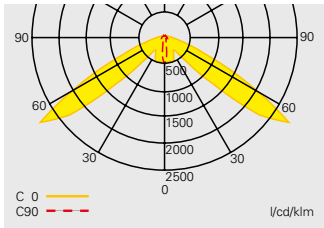

5  
Escape route illumination with asymmetric optics

### Planning help for GuideLed SL CGLine+ with asymmetric optics for E = 1.0 lx (0.5 lx)

Measurement plane 0.02 m, maintenance factor MF = 80 %, battery operation, distances in m

Emergency light operating duration	Mounting height in metres	Mounting types	Mounting types				
			L1	L2	L3	L4	
1 h	2.5	Ceiling mounting	1.6 (2.9)	5.8 (7.4)	5.9 ( 6.6)	13.2 (14.7)	
	3.0	Escape route. central	1.3 (3.0)	5.8 (7.9)	6.6 ( 7.5)	15.0 (16.6)	
	3.5		1.1 (2.2)	4.5 (8.2)	7.3 ( 8.3)	16.6 (18.5)	
	4.0		1.1 (1.9)	3.9 (8.4)	8.1 ( 9.0)	18.0 (20.3)	
	4.5		1.1 (1.7)	3.4 (7.3)	8.7 ( 9.7)	19.3 (22.0)	
	5.0		1.1 (1.6)	3.2 (6.3)	9.4 (10.4)	20.9 (23.6)	
	5.5		1.0 (1.5)	3.0 (5.7)	10.0 (11.2)	22.4 (25.0)	
	6.0		1.0 (1.5)	3.0 (5.1)	10.5 (11.9)	23.8 (26.4)	
	6.5		1.0 (1.5)	3.1 (4.7)	3.6 (12.6)	20.6 (27.8)	
	7.0		1.0 (1.5)	3.0 (4.6)	3.5 (13.2)	19.0 (29.3)	
	7.5		0.9 (1.5)	3.0 (4.3)	3.4 (13.8)	19.2 (30.8)	
	8.0		0.9 (1.4)	2.9 (4.2)	3.3 (14.4)	19.6 (32.3)	
	8.5		0.8 (1.4)	2.9 (4.3)	3.1 (14.9)	20.0 (33.7)	
	3 h	2.5	Ceiling mounting	1.0 (2.3)	4.5 (6.4)	5.4 ( 6.2)	12.3 (13.7)
		3.0	Escape route. central	0.9 (1.7)	3.4 (6.7)	6.2 ( 6.9)	13.9 (15.6)
3.5			0.9 (1.4)	2.9 (6.5)	6.9 ( 7.6)	15.3 (17.3)	
4.0			0.9 (1.3)	2.6 (5.1)	7.5 ( 8.4)	16.7 (18.9)	
4.5			0.8 (1.2)	2.4 (4.5)	8.1 ( 9.1)	18.2 (20.4)	
5.0			0.8 (1.2)	2.5 (4.0)	8.7 ( 9.8)	19.6 (21.7)	
5.5			0.8 (1.2)	2.5 (3.7)	2.8 (10.4)	15.6 (23.2)	
6.0			0.8 (1.2)	2.4 (3.5)	2.7 (11.1)	15.5 (24.7)	
6.5			0.7 (1.1)	2.3 (3.4)	2.6 (11.6)	15.8 (26.2)	
7.0			0.5 (1.1)	2.3 (3.5)	2.4 (12.2)	16.3 (27.5)	
8 h	7.5		0.2 (1.1)	2.3 (3.5)	0.7 ( 4.0)	8.1 (23.0)	
	2.5	Ceiling mounting	0.5 (0.8)	1.6 (3.2)	4.7 ( 5.2)	10.4 (11.8)	
	3.0	Escape route. central	0.5 (0.8)	1.5 (2.6)	5.3 ( 5.9)	11.9 (13.2)	
	3.5		0.5 (0.8)	1.5 (2.3)	1.7 ( 6.6)	9.5 (14.6)	
	4.0		0.4 (0.7)	1.4 (2.1)	1.6 ( 7.2)	9.8 (16.1)	
4.5		0.2 (0.7)	1.4 (2.2)	1.3 ( 2.5)	5.1 (15.7)		

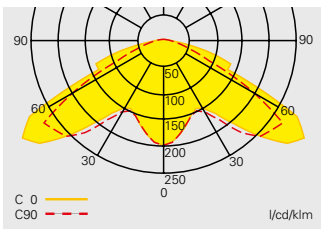

Escape route illumination with symmetric optics

### Planning help for GuideLed SL CGLine+ with symmetric optics for E = 1.0 lx (0.5 lx)

Measurement plane 0.02 m, maintenance factor MF = 80 %, battery operation, distances in m

Emergency light operating duration	Mounting height in metres	Mounting types	Mounting types			
			L1	L2	L3	L4
1 h	2.5	Ceiling mounting	3.8 (4.5)	9.0 (10.2)	4.2 (4.9)	9.7 (11.4)
	3.0	Escape route, central	4.1 (5.0)	10.0 (11.5)	4.4 (5.4)	10.9 (12.4)
	3.5		4.0 (5.4)	10.8 (12.7)	4.4 (5.9)	11.8 (13.7)
	4.0		3.4 (5.8)	11.5 (13.7)	2.4 (6.2)	12.3 (14.9)
	4.5		1.7 (5.8)	11.6 (14.6)	1.7 (6.4)	10.9 (15.9)
	5.0		1.3 (5.6)	11.0 (15.4)	1.3 (6.2)	10.3 (16.7)
	5.5		0.6 (5.1)	10.2 (16.1)	0.6 (5.4)	9.2 (17.3)
3 h	2.5	Ceiling mounting	3.3 (4.1)	8.2 ( 9.5)	3.6 (4.5)	8.9 (10.2)
	3.0	Escape route, central	3.1 (4.5)	9.0 (10.6)	3.4 (4.9)	9.7 (11.5)
	3.5		1.5 (4.7)	9.4 (11.5)	1.5 (5.1)	9.0 (12.6)
	4.0		1.0 (4.6)	8.9 (12.4)	1.1 (5.0)	8.3 (13.5)
	4.5		0.4 (4.0)	8.0 (13.1)	0.4 (3.0)	6.1 (14.0)
8 h	2.5	Ceiling mounting Escape route, central	0.6 (2.8)	5.5 ( 7.7)	0.7 (3.1)	5.2 ( 8.4)

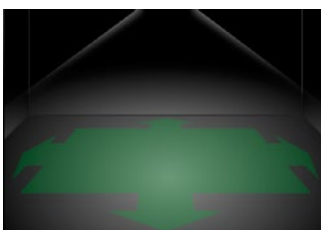
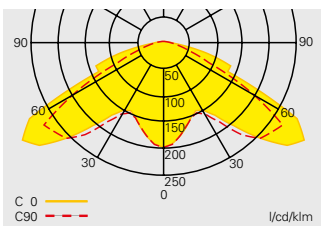

Room illumination with symmetric optics

### Planning help for GuideLed SL CGLine+ with symmetric optics for E = 1.0 lx (0.5 lx)

Measurement plane 0.02 m, maintenance factor MF = 80 %, battery operation, distances in m

Emergency light operating duration	Mounting height in metres	Mounting types	Mounting types			
			L1	L2	L3	L4
1 h	2.5	Ceiling mounting	3.4 (4.3)	8.8 (10.2)	3.2 (3.9)	8.1 ( 9.0)
	3.0	Room illumination	3.4 (4.5)	9.4 (11.3)	3.5 (4.2)	9.4 (10.3)
	3.5		3.4 (4.4)	10.3 (12.5)	3.5 (4.2)	10.2 (11.3)
	4.0		3.4 (4.4)	11.0 (13.5)	3.4 (4.2)	10.9 (12.3)
	4.5		0.7 (4.9)	11.3 (13.9)	1.6 (4.7)	11.5 (13.7)
	5.0		0.6 (5.0)	10.5 (14.7)	1.1 (4.7)	11.4 (14.5)
	5.5		0.5 (4.4)	10.1 (15.5)	0.5 (4.5)	11.3 (15.1)
	6.0		0.7 (2.4)	10.8 (15.9)	0.5 (2.5)	10.0 (15.9)
	6.5		0.5 (0.7)	9.9 (15.6)	0.5 (1.9)	10.3 (16.2)
	7.0		0.5 (0.7)	9.1 (14.9)	0.5 (1.6)	9.9 (16.1)
3 h	2.5	Ceiling mounting	2.9 (3.4)	7.7 ( 9.5)	2.9 (3.3)	7.7 ( 8.3)
	3.0	Room illumination	3.0 (4.0)	8.5 (10.4)	2.9 (3.5)	8.5 ( 9.5)
	3.5		1.4 (4.0)	9.2 (11.0)	2.0 (3.8)	9.1 (10.8)
	4.0		0.5 (4.1)	8.5 (11.7)	1.1 (4.0)	9.2 (11.7)
	4.5		0.7 (4.0)	8.2 (12.4)	0.5 (3.4)	8.9 (12.4)
8 h	2.5	Ceiling mounting	0.6 (2.4)	5.2 ( 7.2)	0.9 (2.7)	5.7 ( 7.3)
	3.0	Room illumination	0.7 (1.4)	5.4 ( 8.0)	0.5 (2.1)	5.0 ( 7.9)
	3.5		0.5 (0.7)	4.6 ( 7.5)	0.5 (0.9)	4.9 ( 8.0)
	4.0		0.6 (0.5)	4.0 ( 7.0)	0.5 (0.5)	3.9 ( 8.0)
	4.5		0.7 (0.6)	2.4 ( 7.2)	0.5 (0.5)	2.5 ( 7.2)
5.0		0.5 (0.5)	1.4 ( 6.4)	0.5 (0.5)	1.4 ( 6.9)	