

Product, technical characteristics and features

FILA²70

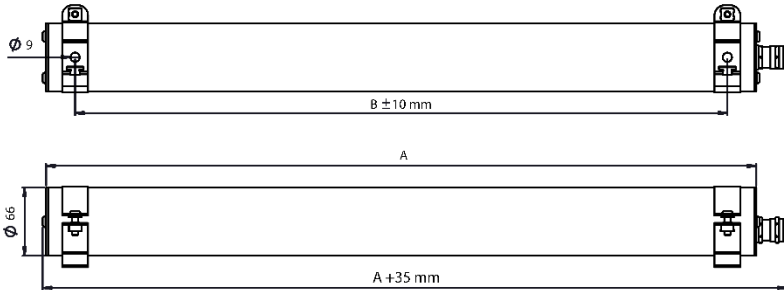

VERSION	Nb of modules	TYPE	A (mm)	B (mm)
without detection	2	LED	690	634
without detection	3	LED	970	914
without detection	4	LED	1250	1194
without detection	5	LED	1555	1499
with detection	2	LED	855	799
with detection	3	LED	1135	1079
with detection	4	LED	1415	1359
with detection	5	LED	1695	1639

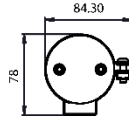

Standard installation kit:

- Flat connector with cover x1
- Flange for flat connector x1
- Brackets for wall mounting x2

General characteristics:

- Nominal voltage: 220-240 V AC - 50 / 60Hz
- Input voltage range: 198-264 V AC
- Protection class: I
- Protection rating: IP 67
- Mechanical impact resistance rating: IK10 / 20 J

Light source: LED Modules.

Power(s): as per label product.

Reference(s): as per label product.

- Standard reference: 73-74xxx00 no detection (see this instruction)
- Options regarding the end of product's reference (see specific instructions):
 - 73-74xxx21 Dali dimmable + switch dimming + standby warning
 - 73-74xxx12 with Pro detection
 - 73-74xxx14 with Pro detection + extinction warning
 - 73-74xxx15 with Pro detection + standby warning
 - 73-74xxx16 with Pro detection + radio-control
 - 73-74xxx04 slave version + extinction warning
 - 73-74xxx05 slave version + standby warning

Other reference(s) with option(s):

- See specific instructions.

FILA²100

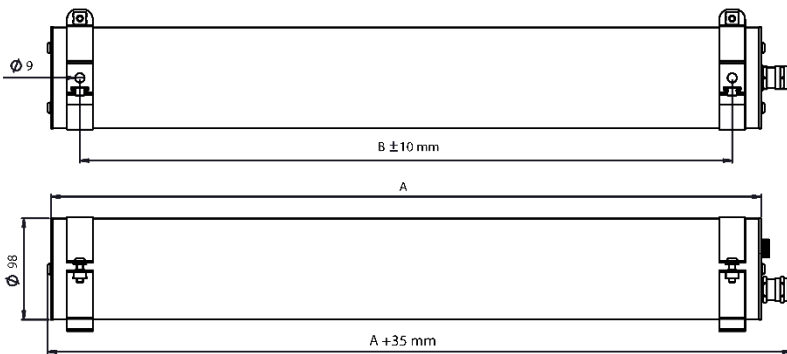

VERSION	Nb of modules	TYPE	A (mm)	B (mm)
without detection	2	LED	690	634
without detection	3	LED	970	914
without detection	4	LED	1250	1194
without detection	5	LED	1555	1499
with detection	2	LED	855	799
with detection	3	LED	1135	1079
with detection	4	LED	1415	1359
with detection	5	LED	1695	1639

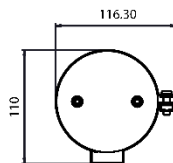

Conditions of use

Horizontal position: LED version.

Vertical position: LED version (cable gland downwards).

Mounting / Installation



Warning, versions employing LEDs are at risk from ESD (electrostatic discharges).



Fitting & installation must be carried out by a professional installer in accordance with current installation standards.



Isolate the power before fitting and connecting up.

Opening the luminaire:

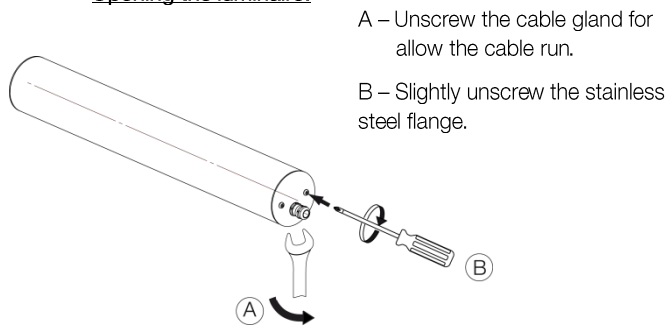

Open the stainless steel flange.

Slightly remove the geartray to have an access to the connector.

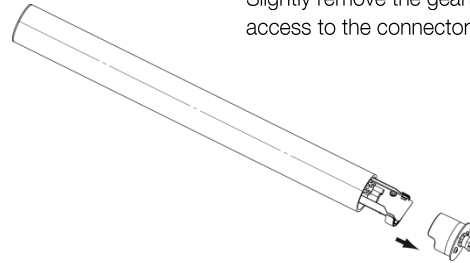

Fixing:

To mount the luminaire, use the supplied brackets with diameter 8mm flat head screws and suitable plugs, according to the type of the wall, to ensure a maximal lever resistance. Screws and plugs are not supplied with the luminaire.

Preparing the cable entry grommet class 1 (Standard reference 73-74xxx00):

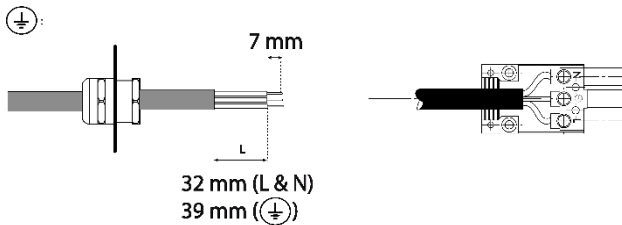

The cable must be prepared as per the diagrams. Respect the polarity. Put the flange of the flat connector.

Preparing the cable entry grommet class 2 (Standard reference 73-74xxx009502):

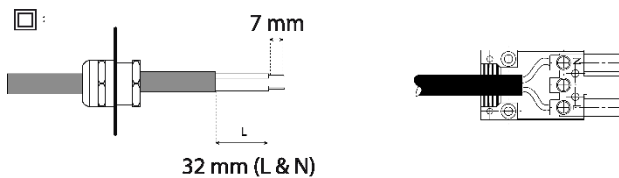

The cable must be prepared as per the diagrams. Respect the polarity. Put the flange of the flat connector.

➤ For other cases, refer to the specific instructions for connection and splitting off.

Closing the luminaire:

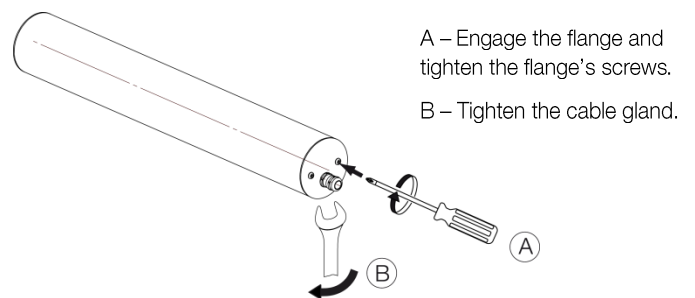
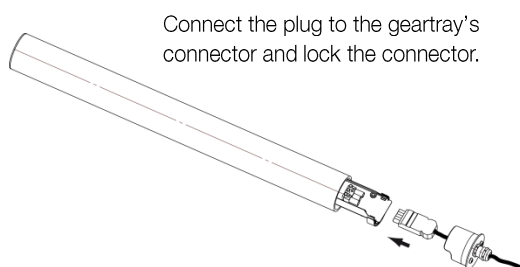

Cleaning

Cleaning of the luminaire is limited to cleaning the diffuser for proper light output. Clean the diffuser (luminaire must be closed) using a damp cloth or with soapy water.



DO NOT USE DETERGENT

Maintenance

In order to prevent any risks, maintenance on the luminaire must be carried out by a professional installer or an authorized person with equivalent qualifications.

Replace the light source(s) when worn out.

Recyclability



The FILA 2 is an eco-designed luminaire:

- All the plastic or metal components can be dismantled and recycled via appropriate facilities.
- All the electronic components such as the LED circuit, power supply, etc. can be dismantled and recycled via appropriate facilities.